

TOWN AND COUNTRY PLANNING ACT 1990
Town and Country Planning (Tree Preservation) (England) Regulations 2012

Bromsgrove District Council Tree Preservation Order (12) 2024
Tree/s on land at 98 New Road, Bromsgrove, Worcestershire, B60 2LB,

Bromsgrove District Council in exercise of the powers conferred on them by section 198 of the Town and Country Planning Act 1990 make the following Order—

Citation

1. This Order may be cited as **Tree Preservation Order (12) 2024**

Interpretation

- 2.— (1) In this Order “the authority” means Bromsgrove District Council.
(2) In this Order any reference to a numbered section is a reference to the section so numbered in the Town and Country Planning Act 1990 and any reference to a numbered regulation is a reference to the regulation so numbered in the Town and Country Planning (Tree Preservation)(England) Regulations 2012.

Effect

- 3.— (1) Subject to article 4, this Order takes effect provisionally on the date on which it is made.
(2) Without prejudice to subsection (7) of section 198 (power to make tree preservation orders) or subsection (1) of section 200 (tree preservation orders: Forestry Commissioners) and, subject to the exceptions in regulation 14, no person shall—
 - (a) cut down, top, lop, uproot, wilfully damage, or wilfully destroy; or
 - (b) cause or permit the cutting down, topping, lopping, uprooting, wilful damage or wilful destruction of,any tree specified in the Schedule to this Order except with the written consent of the authority in accordance with regulations 16 and 17, or of the Secretary of State in accordance with regulation 23, and, where such consent is given subject to conditions, in accordance with those conditions.

Application to trees to be planted pursuant to a condition

4. In relation to any tree identified in the first column of the Schedule by the letter “C”, being a tree to be planted pursuant to a condition imposed under paragraph (a) of section 197 (planning permission to include appropriate provision for preservation and planting of trees), this Order takes effect as from the time when the tree is planted.

Dated this *17th day of May 2024*

Signed on behalf of Bromsgrove District Council

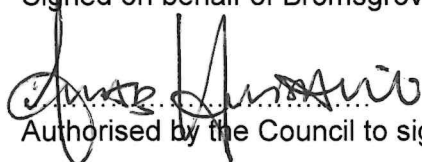

Authorised by the Council to sign in that behalf

First Schedule

Trees specified individually

(encircled in black on the map)

<u>No. on Map</u>	<u>Description</u>	<u>NGR</u>	<u>Situation</u>
T1	Lime	396668, 269848	On Eastern boundary of site with New Road
T2	Lime	396626, 269844	Northern boundary with 1 Clive Road B60 2AY
T3	Sweet Chestnut	396620, 269842	Northern boundary with 3 Clive Road B60 2AY
T4	Pine	396624, 269818	Western boundary of site
T5	Pine	396629, 269820	Western boundary of site
T6	Sweet Chestnut	396640, 269822	Western boundary of site
T7	Lime	396663, 269826	Western boundary of site in Drayton Court

Trees specified by reference to an area

(within a dotted black line on the map)

<u>No. on Map</u>	<u>Description</u>	<u>NGR</u>	<u>Situation</u>
-------------------	--------------------	------------	------------------

NONE

Groups of Trees

(within a broken black line on the map)

<u>No. on Map</u>	<u>Description</u>	<u>NGR</u>	<u>Situation</u>
-------------------	--------------------	------------	------------------

NONE

Woodlands

(within a continuous black line on the map)

<u>No. on Map</u>	<u>Description</u>	<u>NGR</u>	<u>Situation</u>
-------------------	--------------------	------------	------------------

NONE

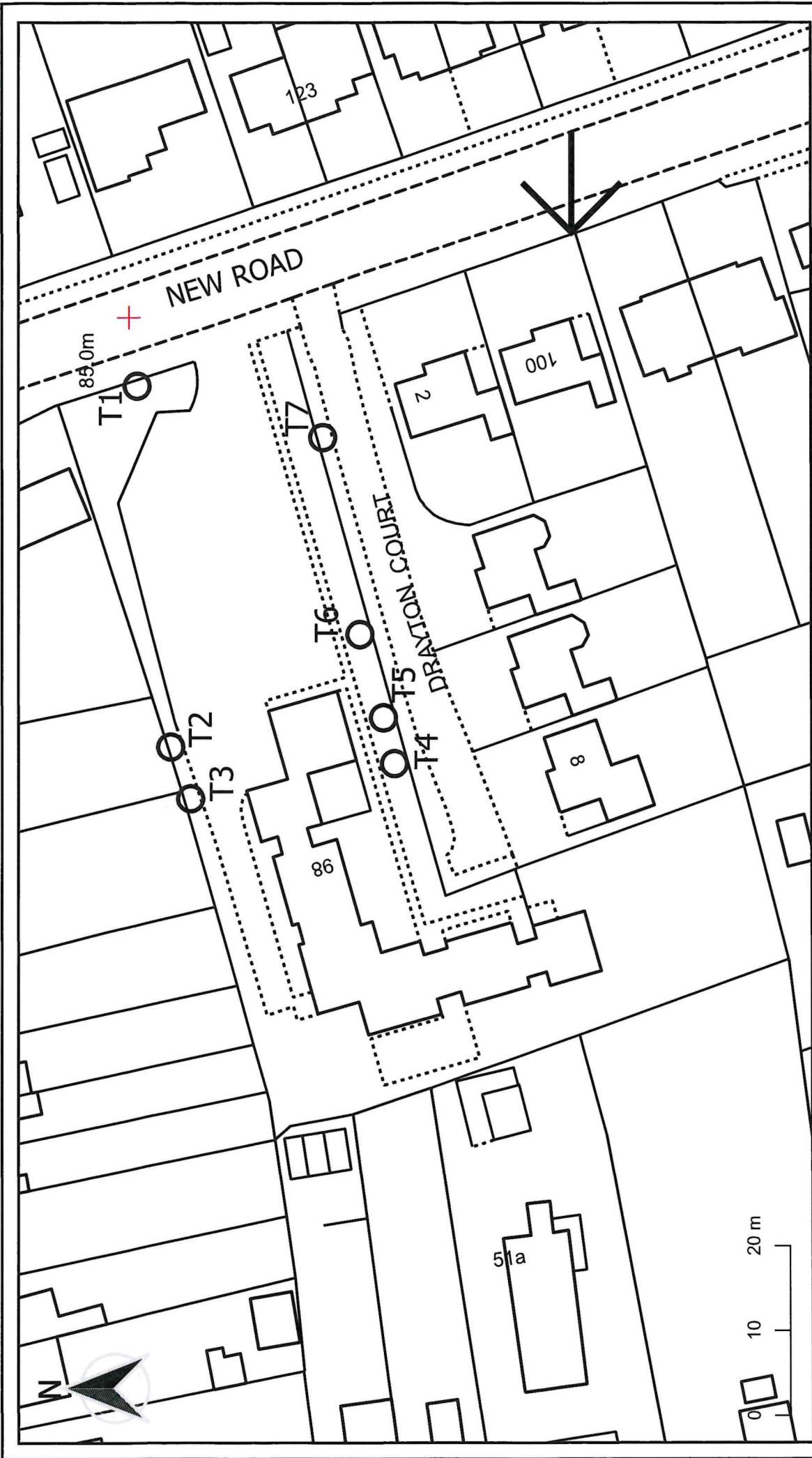

Stuart Murray
 17/05/2024
 APPROVED SIGNATURES

Environmental Services Town Hall Walter Stranz Square Redditch Worces B98 8AH	@ Crown copyright and database rights 2024 Ordnance Survey 100023252
Gavin Boyes - Drawn: rboricultur Team	1:600 Scale: @A4 Date: 5.2024
Bromsgrove Council TPO (12) 2024	98 New Road Bromsgrove B60 2LB 1 of 1



Redditch Borough Council
 making difference
www.redditchbc.gov.uk

Bromsgrove District Council
www.bromsgrove.gov.uk